

Metal Y-Axis Belt Plate Installation

12.17.15

1. Insert belt in top hole of plate with ribbed side down, then loop belt through lower hole.
2. Place metal belt clamp on top of belt with spikes facing down.

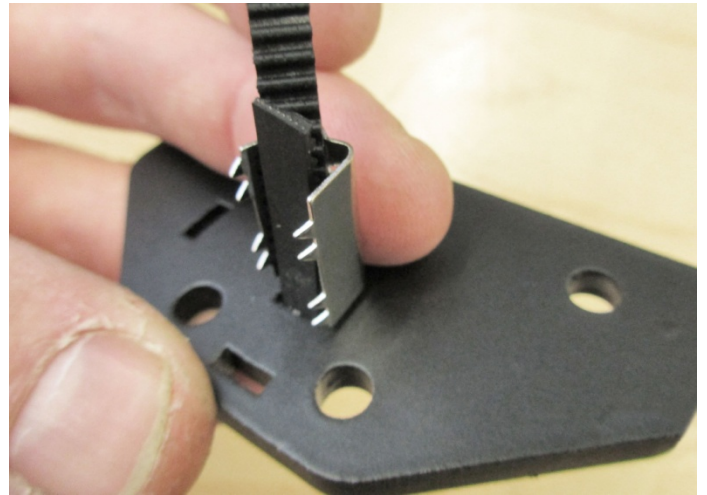
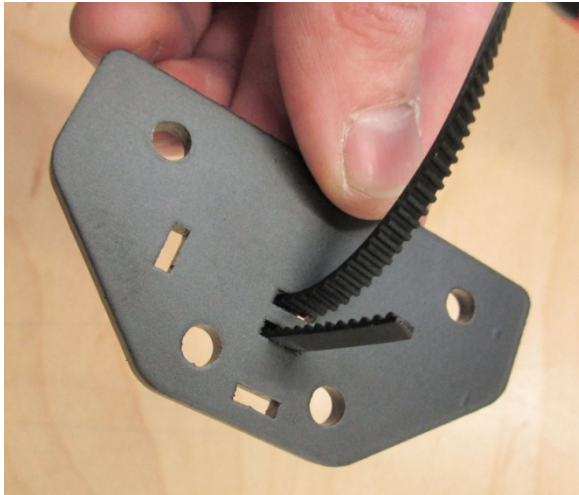

3. Using pliers bend one side of the clamp so it presses down on belt.
4. Bend the second side of the clamp down

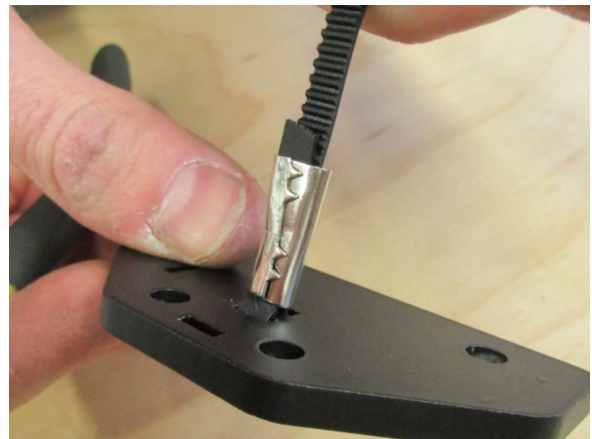

5. Install belt on gMax frame through rear pulley and front motor.

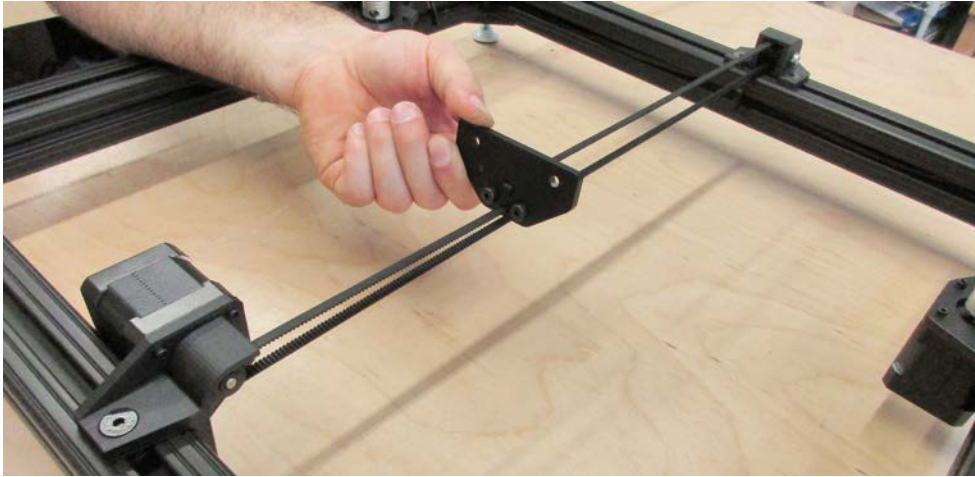

6. After belt has been run, insert belt in lower portion of metal plate.
7. Insert (2) M5x10mm low profile screws in lower holes and screw into double tnut on back side. Make sure raised edges of tnut face out

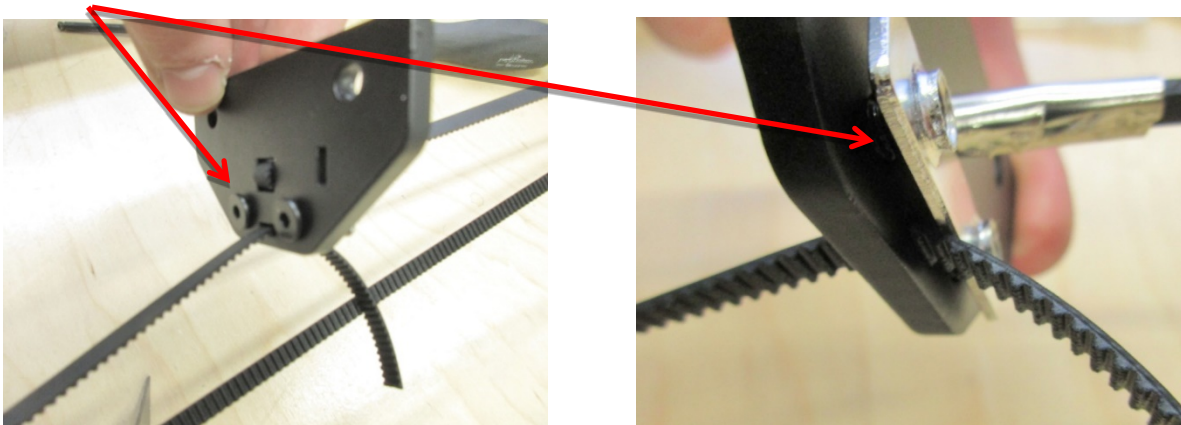

8. Pull belt tight while tightening M5x10mm bolts
9. Install belt plate on front of v-slot rail on aluminum bed

10. Remaining belt should be inserted in vertical slot on plate.

11. To tighten the belt in the future simply loosen the double t-nut and pull belt tight

